



## SECTION 1

# ILLUMINATORS



# Fiberstars 2007 Product Book



## 6004 / 6004-AS SERIES ILLUMINATORS - (METAL HALIDE)

4 position color wheel: white - blue - green - magenta

### Specifications:

#### Construction

Enclosure: High-Impact Outdoor Grade Polycarbonate

Ventilation: 110 ft<sup>3</sup> /min.

Acoustic Rating: 50dB (A)

Weight: 20 lbs.

Maximim Fiber Capacity:6004/6004-AS 450 strand capacity

\*Add our optional Constant Color System to increase to 600 strands(see pgs 12-13)

#### Electrical

Voltage Requirement: 120 VAC, 60 Hz

Power Consumption: 200 Watts max

Start Current Load: 4.4 amps

Run Current Load: 1.8 amps

#### Lamp

Type: Metal-Halide H.I.D., Proprietary Design

Life: 6000 Hours Average

Cool Down/Restrike Period: 2-3 minutes

Replacement Lamp Assembly No.: Y20-6000

Color Temperature: 4300° K

#### Options

Wireless Pool Controls (WPC).

**6004 and 6004-AS can be used with WPC1, WPC2 and WPC3**

**(See pages 14-24)**

**Internal wireless Remote Control see RM6000**

**Pool Temperature Monitor (PTM)**



Part #	Description	List \$
6004	Metal-Halide Illuminator, 4-Position Color Wheel, 450 Port Capacity	\$699.57
6004-AS	Metal-Halide Illuminator, 4-Pos Color Wheel, 450 Port Capacity AUTO SYNCH	\$839.94
<b>*All 6004-AS units do not require communication cables and can be synchronized with all Jazz Light™ AS Units*</b>		
RM-6000	Internal Wireless Remote Control System for 6004 Illuminator	\$189.96
<b>WPC</b>	<b>Wireless Pool Conrols See pages 14 - 24</b>	
<b>PTM</b>	<b>Pool Temperature Monitor See page 24</b>	



## 2004/ 2004-AS SERIES ILLUMINATORS - (QUARTZ HALOGEN)

4 position color wheel: white - blue - green - magenta

### Specifications:

#### Construction

Enclosure: High-Impact Outdoor Grade Polycarbonate

Ventilation: 110 ft<sup>3</sup> /min.

Acoustic Rating: 50dB (A)

Weight: 15 lbs.

Maximum Fiber Capacity: 2004/2004-AS 400 strand capacity

\*Add our optional Constant Color System to increase to 450 strands

(See page 12-13)

#### Electrical

Voltage Requirement: 120 VAC, 60 Hz

Power Consumption: 250 Watts Max

Current Load: 2.0 amps

#### Lamp

Type: Quartz-Halogen, Proprietary Design

Life: 400-700 Hours Average

Replacement Lamp Number: HI-111

Color Temperature: 2800° K

#### Options

##### Wireless Pool Controls (WPC).

2004 and 2004-AS can be used with WPC1, WPC2 and WPC3

WPC-04 can only be used with 2004-AS

(See pages 14-24)

Internal wireless remote see RM1

(For use on single units only. NOT for synchronized units.)

##### **Pool Temperature Monitor (PTM)**

Wireless Pool Temp read out inside the home!



**Note:**  
**2004-AS**  
**Auto Synch (AS)**  
**units have a 3 wire**  
**operation.**

Part #	Description	List \$
2004	Quartz-Halogen Illuminator, 4-Position Color Wheel, 400 Port Capacity	\$465.60
2004-AS	Quartz-Halogen Illuminator, 4-Pos Color Wheel, 400 Port Capacity AUTO SYNCH -Has 3 wire installation, 1 control switch.	\$605.98

**\*All 2004-AS units do not require communication cables\***

RM1	Remote Control - Wireless for 2004 & individual 2004-AS units. NOT for synchronized units.	\$189.96
WPC	<b>Wireless Pool Controls See pages 14- 24</b>	
PTM	<b>Pool Temperature Monitor See page 24</b>	



# Fiberstars 2007 Product Book

## 409 SERIES ILLUMINATOR (SPECIAL ORDER ONLY!)



This commercial-grade, 150-Watt metal halide illuminator is designed for added brightness. Great for use on Fiberstars Lighted Laminars in high ambient light areas. Allow 2 - 3 weeks for delivery.

### Lamp

Type: Metal-Halide H.I.D., Proprietary Design

Life: 6000 Hours Average

Replacement Lamp Number: HID 440

### Includes

Complete Fiber Optic Illuminator

Fiber Optic Port Assembly

Installation and Owner's Manual

### Miscellaneous

Fiber Capacity: 400 strands

### Options

**Wireless Pool Controls (WPC).**

(See pages 14-24)

### **Pool Temperature Monitor (PTM)**

Wireless Pool Temp read out inside the home!



Part #	Description	List \$
409-W	409 Series, Commercial-Grade Illuminator - Metal Halide White Light Only	\$1,310.10
409-C-4	409 Series, Commercial-Grade Illuminator - Metal-Halide 4-Position Color Wheel	\$1,384.13
409-C4M	409 Series, Commercial-Grade Illuminator - Metal-Halide 4-Position Color Wheel, Master Unit	\$1,694.38
409-C4S	409 Series, Commercial-Grade Illuminator - Metal-Halide 4-Position Color Wheel, Slave Unit	\$1,646.65
409-C8	409 Series, Commercial-Grade Illuminator - Metal-Halide 8-Position Color Wheel	\$1,431.70
409-C8M	409 Series, Commercial-Grade Illuminator - Metal-Halide 8-Position Color Wheel, Master Unit	\$1,885.28
409-C8S	409 Series, Commercial-Grade Illuminator - Metal-Halide 8-Position Color Wheel, Slave Unit	\$1,836.91
HID-440	Replacement metal-halide Lamp	\$352.00

**WPC**      **Wireless Pool Controls See pages 14 - 24**

**PTM**      **Pool Temperature Monitor See page 24**

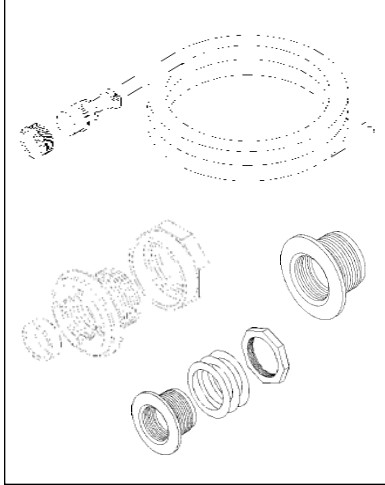

## TOTAL FIBER SYSTEM (T.F.S.)

Now you can create the brilliant color magic of fiber optics for your pool with a single purchase! Our Total Fiber System (T.F.S.) features the 6004 multi-color Illuminator. You also receive 12' or 18' of our 375 Strand fiber - the industry's largest mainpool bundle. All of this AND MORE come in one box to make your fiber purchasing much easier!

Specifications of 6004 Illuminator: See Page 8.

### Includes

- 6004 Series Illuminator - Metal Halide 4-Position Color Wheel
- Standard Port Tip Assembly
- 12' or 18' of 375 Strand Fiber
- Gunite, Vinyl and Fiberglass Wall Fitting (All included)
- Installation Base
- Fiber Optic Port Assembly
- Installation Manual
- Owner's Manual

\*Constant Color port tips (CCS) can be purchased separately. (See page 12-13)



**Compatible with Fiberstars' WPC controls. (See pages 14-24)**

Part #	Description	List \$
TFS-12	Complete One Box System featuring 4-Pos. Color Wheel, standard port tips and 12' of 375 strand fiber	\$1,054.26
TFS-18	Complete One Box System featuring 4-Pos. Color Wheel, standard port tips and 18' of 375 strand fiber (See above for complete package details.)	\$1,160.13
<b>Option</b>		
RM-6000	Wireless Remote Control System for 6004 Illuminator	\$189.96
<b>WPC</b>	<b>Wireless Pool Controls See pages 14- 24</b>	



# Fiberstars 2007 Product Book

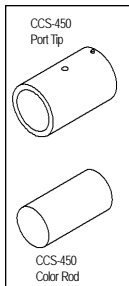

Constant Color System  
450 Strands

## CONSTANT COLOR SYSTEM - PORT ASSEMBLIES

**Our exclusive, new patented Constant Color System allows all fibers to change color precisely at the same time, creating unique shades of blended color.**

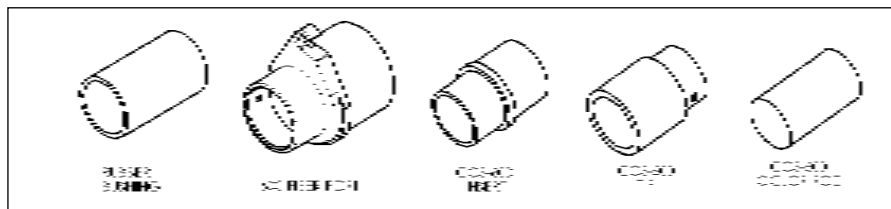

Constant Color System  
451 - 600 Strands

Part #	Description	List \$
CCS-450	Patented Constant Color System Port tip - 450 fiber capacity	\$42.48
CCS-600	Patented Constant Color System Port tip - 600 fiber capacity (with new port body for high capacity)	\$82.91

## CONSTANT COLOR SYSTEM: PORT ASSEMBLY INSTRUCTIONS 451 - 600 FIBERS

A. Ensure that the total fiber count of all fiber strands is between 451 and 600. If you have more than 600 fibers you will need a second illuminator. The maximum capacity of this Constant Color System port is 600 fibers.

B. Install the Insert into compression fitting and fully seat insert (Fig. 1).

C. Strip back all fiber casings no less than 4 inches (Fig. 2). Take care not to nick the fibers.

D. Insert the bare fibers into the insert so that ALL fibers protrude past the insert end (Fig. 3). Tighten the port compress nut down on the fiber casing (Fig. 4). If fiber casing will not go into the compression fitting then install the rubber bushing into the fitting half-way. (Fig 2a) Then insert the bare fibers until the fiber casing is in contact with the bushing. Tighten the port compress nut down on the bushing.

**E. IMPORTANT: If the insert is not completely full, insert scrap individual fibers into the insert until it is completely full (Fig. 5). This will keep the lit fibers perpendicular to the lamp and prevent the fibers from overheating.**

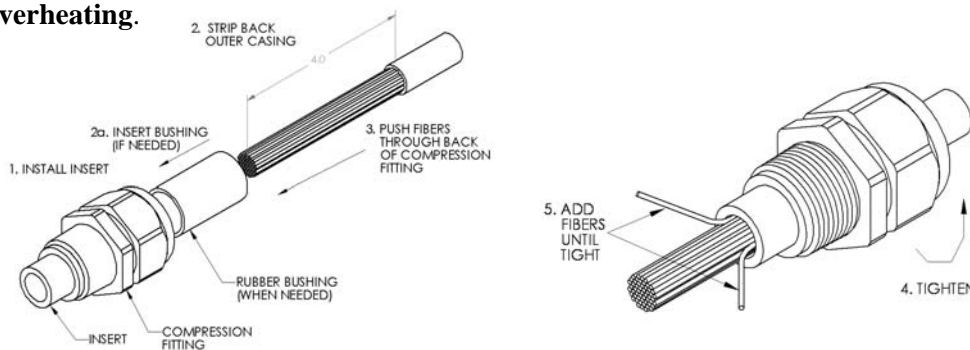

**Note: It is important that you match your fiber bundle with the correct size CCS.**

**For example: Use a CCS-450 for 450 strands. Do not use a CCS-600.**

## CONSTANT COLOR SYSTEM: PORT ASSEMBLY INSTRUCTIONS (CONT'D)

F. Heat up hot knife (PN FS-118 or FS-163). Once hot knife is up to temperature, apply firm downward pressure on the fibers, with the blade touching the insert at a slight angle (Fig 6). **DO NOT SAW BACK AND FORTH.** Allow the heat of the knife to slowly trim the fibers. Ease the pressure off as the knife starts to complete the cut. Turn the hot knife off and allow it to cool in a safe place.

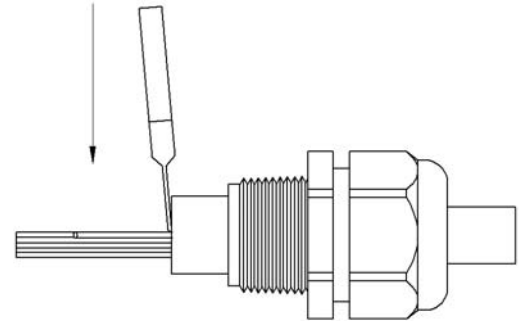

6. APPLY STEADY DOWNWARD FORCE WITH HOT KNIFE  
DO NOT SAW BACK AND FORTH

G. Line up hole on insert with hole on the port and fully seat the insert on the port (Fig. 7).

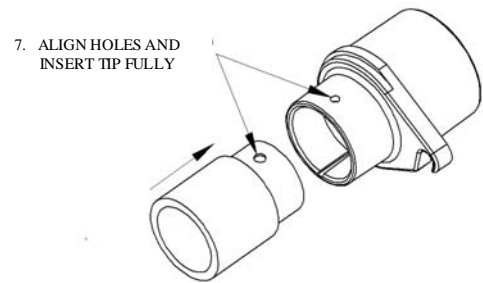

7. ALIGN HOLES AND  
INSERT TIP FULLY

H. Slide the constant color rod inside the insert until the end is flush with the end of the tip (Fig. 8). Use the set screw to lock the constant color rod and tip in place (Fig. 9). **DO NOT OVER TIGHTEN!** Set screw should be just tight enough to keep the constant color rod and port tip in place.

9. INSTALL SET SCREW  
DO NOT OVERTIGHTEN

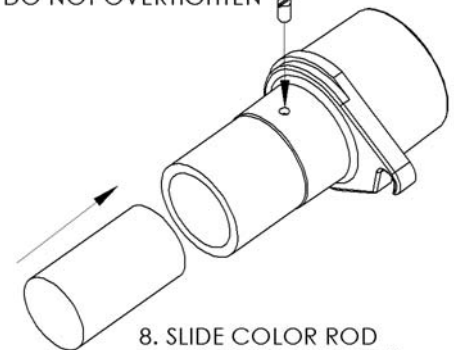

8. SLIDE COLOR ROD  
INTO TIP UNTIL END IS  
FLUSH WITH END OF THE  
PORT TIP.

I. Screw port assembly onto compression fitting until fully seated (Fig. 10)

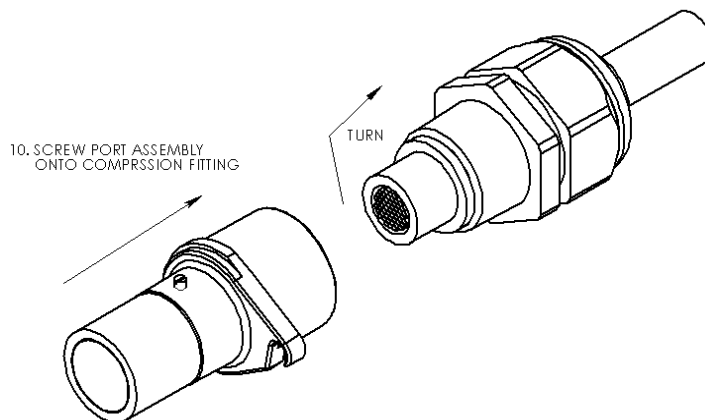

10. SCREW PORT ASSEMBLY  
ONTO COMPRESSION FITTING